

PRINTING SPECIFICATIONS:

8-1/2" X 11"

PRINT 2-SIDED. GBC BINDING. BLACK SPIRAL.

FRONT COVER: TEXT - BLACK INK, WHITE COATED CARD STOCK.

CONTENT PAGES: BLACK INK, PRINT 2-SIDED.

BACK COVER: BLACK INK, WHITE COATED CARD STOCK

NOTE: ANY REVISION TO NORM-O-TEMP, MODEL 111Z OPERATION MANUAL 57425  
MUST BE REFLECTED IN THIS DOCUMENT (IF APPLICABLE)

SEE DOCUMENT CONTROL FOR OMITTED MANUAL REVISIONS

[K]	CHANGED "HANSEN" TO "QUICK DISCONNECT". ECN M1902-5543	JAB	08-09-19
[J]	UPDATED WARNINGS TO ADDRESS FIELD ACTION FA2019-005. ECN M1906-5627	BMW	6/24/19
[I]	UPDATED COMPANY NAME AND LOGO. ECN M605-5102	EMD	6/13/16
[H]	CLARIFIED OPERATING RANGE. REVISION G WAS NEVER RELEASED. ECN M409-4826	JRU	7/27/15
[G]	UPDATED CONTROLLER RANGE TEMPERATURE FROM 20°C TO 32°C. ECN M409-4826	JRU	7/14/15
[A]	ORIGINAL RELEASE ECN M011-4052	MPM	2/22/12
REV	REVISION	BY	DATE

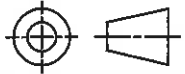

THIRD ANGLE PROJECTION

DIMENSIONS IN INCHES  
UNLESS OTHERWISE  
SPECIFIED



**A GENTHERM COMPANY**

CINCINNATI SUB-ZERO PRODUCTS, LLC.  
12011 MOSTELLER ROAD  
CINCINNATI, OH 45241

PHONE: 513-772-8810

FAX: 513-772-9119

EMAIL: [caz@genthermcsz.com](mailto:caz@genthermcsz.com)

THIS DRAWING HAS BEEN CREATED AND PREPARED BY CSZ. IT IS THE CONFIDENTIAL, EXCLUSIVE PROPRIETARY PROPERTY OF CSZ. USE OF THIS DRAWING OR OF THE PROPRIETARY CONCEPTS INCORPORATED INTO IT, OR COPIES OR REPRODUCTIONS IN WHOLE OR IN PART, ARE PROHIBITED WITHOUT THE EXPRESS WRITTEN CONSENT OF CINCINNATI SUB-ZERO PRODUCTS.

TOLERANCES UNLESS OTHERWISE SPECIFIED	
FRACTIONS	± 1/32
XX DECIMALS	± .031
XXX DECIMALS	± .010
ANGLES	± 2'

SCALE NOT TO SCALE

DRAWN BY  
MPM 2/21/12

APPROVED BY  
*[Signature]* 8/9/19

APPROVED BY  
*[Signature]* 8/9/19

DESCRIPTION  
COVERSHEET  
NORM-O-TEMP, 115V  
OPERATION MANUAL

MODEL NO. 111Z I.D. NO. 57425

DRAWING NO. 57425 PAGE 1/1 FORM NO. 0513.3

REV K